

- Ⓓ Anschluss **ausschließlich** durch ausgebildete Elektro-Fachkräfte.
- ⒼⒸ Electrical connection is to be made by trained electrical specialists **only**.
- Ⓕ Le branchement doit **uniquement** être effectué par des professionnels.
- Ⓘ Il collegamento deve essere eseguito **solo** da elettricisti specializzati.
- Ⓔ La conexión **sólo** debe ser realizada por electricistas debidamente formados.
- ⒽⒿ A ligação deve ser feita **exclusivamente** por profissional eléctrico especializado.
- ⓃⒻ De aansluiting mag **enkel** gebeuren door erkende vakmensen.
- ⒸⒿ Připojení smí **provádět** pouze kvalifikovaný personál.
- ⒽⒻ Podłączenie **wyłącznie** przez specjalistów-elektryków.
- ⒻⒾ Liittäminen kuuluu **ainoastaan** koulutettujen sähköalan ammattilaisten tehtäviin.
- ⒽⒼⒾ⒮ Подключение проводится только специалистом-электриком.
- ⒽⒿ Bağlantı **sadece** eğitimli elektrik teknisyenleri tarafından yapılmalıdır.
- ⒸⒶ 布线需由专业电工执行

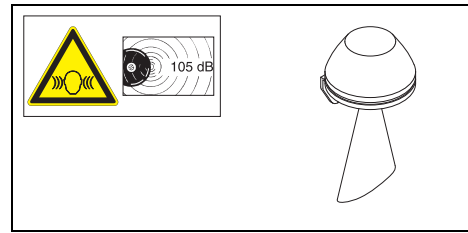

100 Hz	105 dB(A) / 1m
E2620/6	12 V~, 500 mA
E2620/7	24 V~, 350 mA
E2620/2	12 V~, 900 mA
E2620/3	24 V~, 500 mA
E2620/5	230 V~, 70 mA

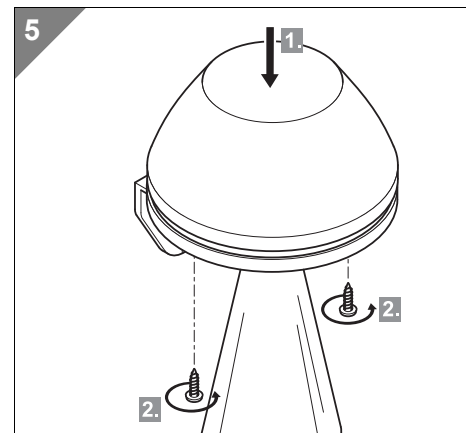
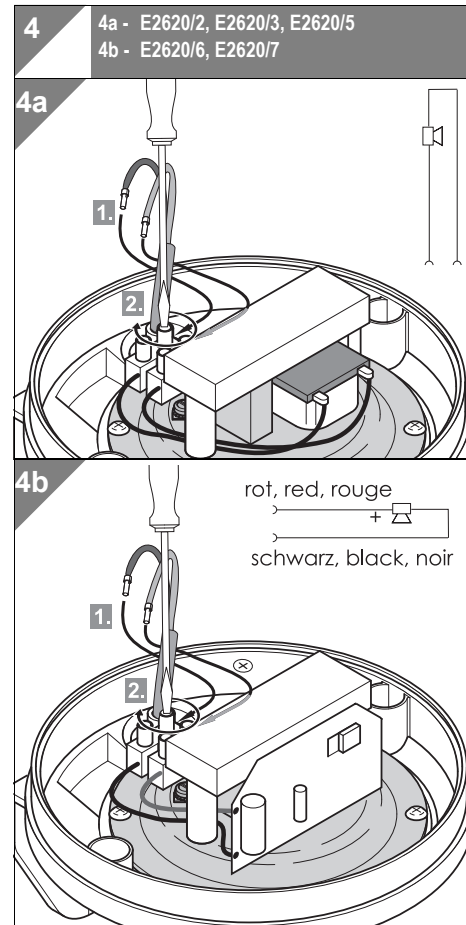
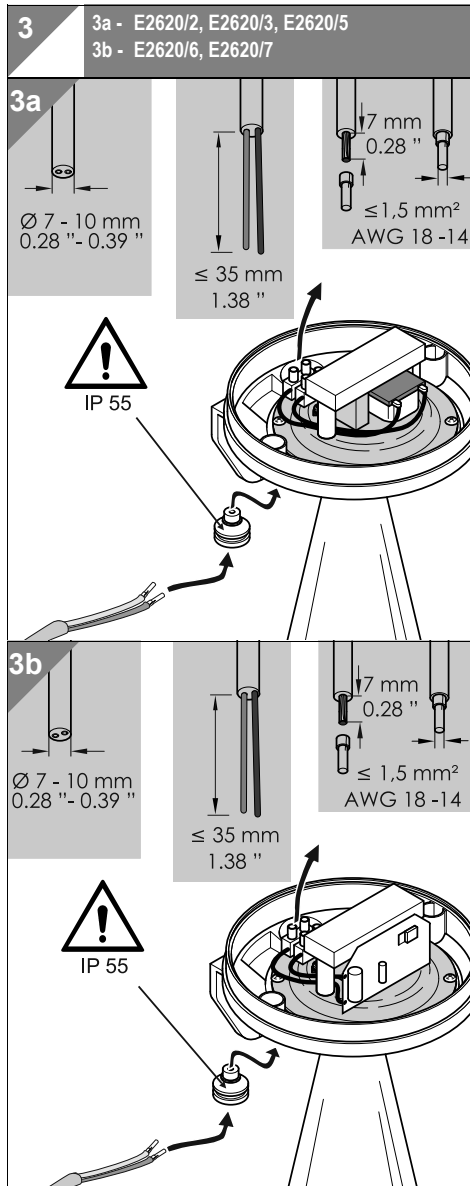
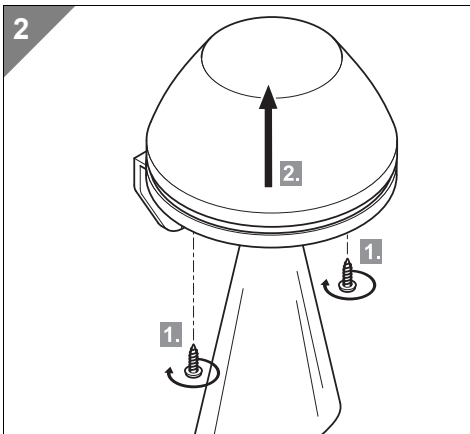
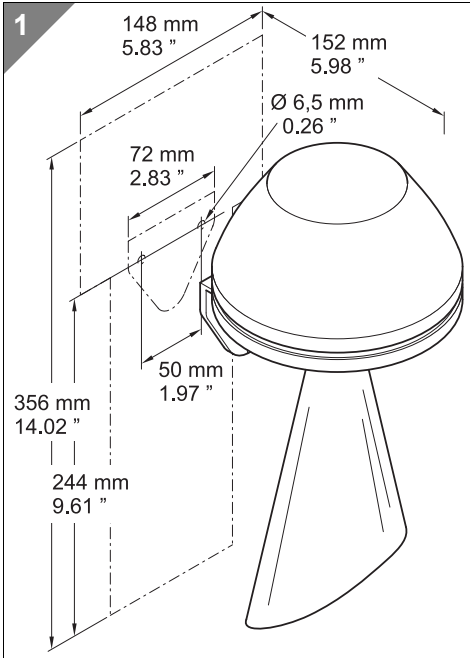

310.570.005.1011

© D

Friedland 
by Honeywell